

ELKAY®**INSTALLATION & USE MANUAL*****SOFT SIDES® Fountains with Vandal Resistant Bubblers
and Vandal Resistant Water Dispenser***

EZLMSN-EDFPVM217DK

LZLMSN-EDFPVM217DK
(Shown with optional ACCESS12X38-5 access panel.)**INSTALLER****CAUTION:**

Review these instructions before beginning installation. Be sure that installation conforms to all plumbing, electrical and other applicable codes.

**WARNING:**

When installation is complete, ensure these instructions are left in the plastic bag provided inside the installed unit for future reference.

**WARNING:**

Service to be performed by authorized service personnel only.

NOTE: It is common practice to ground electrical hardware such as telephones, computers and other devices to available water lines. This can, however, cause electrical feedback in the plumbing circuit, which results in an “electrolysis” effect occurring in the fountain. This may result in water which has a metallic taste to it or has a noticeable increase in the metallic content of the water.

When inspecting plumbing circuit, remember the line may be grounded some distance from the installation, and may occur outside the building or area in which the unit is being installed.

This condition can be avoided (in most cases) by using recommended materials during installation. Any drain fittings provided by the installer should be made of **plastic** which will electronically isolate the fountain from the remainder of the building’s plumbing circuits.

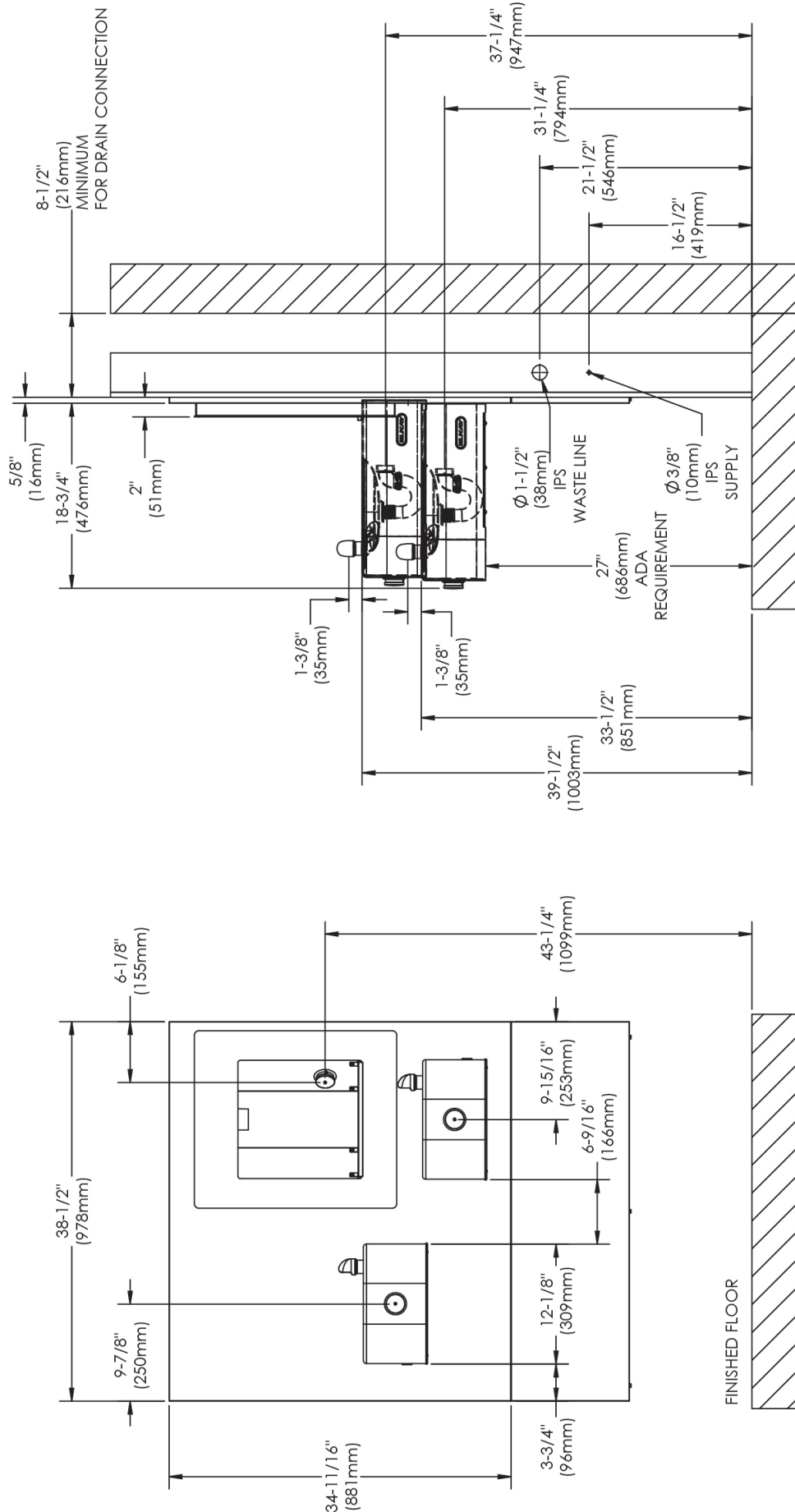

Figure 1 - Rough-in Dimensions

****NEW INSTALLATIONS MUST USE GROUND FAULT CIRCUIT INTERRUPTER *GFCI)**

REQUIRED TOOLS AND MATERIALS

These tables show special tools and/or additional materials (not provided) which are necessary to complete installation of these units:

Special Tools		
Item	Description	Quantity
	NONE	

Additional Materials Not Included		
Item	Description	Quantity
1	Unplated copper inlet pipe	1
2	Service Stop	1
3	90° 1-1/4" Drain Line	1
4	1-1/4" Tee Drain Line	1

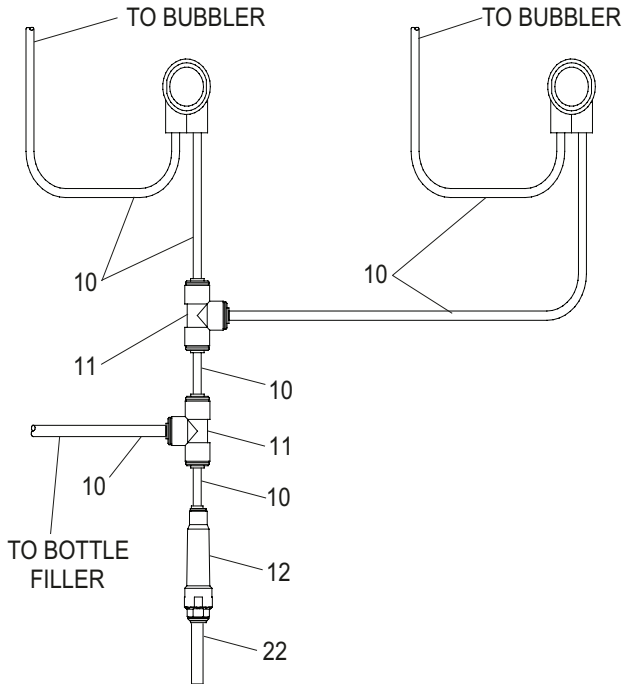

Figure 2 - EZLMSN-EDFPVM217DK Tube Routing

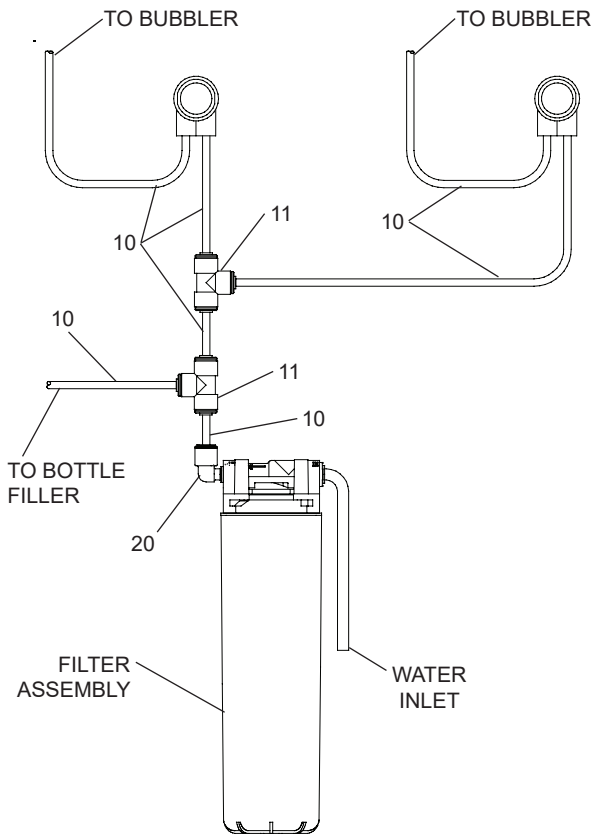

Figure 3 - LZLMSN-EDFPVM217DK Tube Routing

1. **Make** water supply connections (Fig. 10). Install a shut-off valve and union connection to building water-supply (valve and union not provided). Turn on water supply and flush the line thoroughly.

Caution: DO NOT SOLDER tubes inserted into the strainer or filter head as damage to the o-rings may result.

2. **Install** mounting frame (instructions supplied with mounting frame).

3. **(For LZLMSN-EDFPVM217DK)** Install the filter head to the bracket, then install filter bracket on mounting frame (Fig. 8), plumb from the filter outlet using the 1/4" elbow, poly tubing and 1/4 x 1/4 x 1/4" tee, install filter.

3a. **(For EZLMSN-EDFPVM217DK)** Install 1/4" tee, copper tubing and strainer per (Fig. 2).

4. **Install** supplied 4" poly tubing and armaflex to the outlet of the previously installed tee or strainer. Connect supplied 1/4 x 1/4 x 1/4 tee to the 4" poly tubing.

5. **Hang** main panel on mounting frame hanger. Make sure the poly tube do not get pinched between the panel & mounting frame. Ensure the panel engages at the top. Align fountain holes with mounting frame holes.

6. **Remove** protective coating from main panel.

7. **Installing water Dispenser** Place the unit into the stainless panel and frame. Align the holes in the water dispenser with the nuts in the panel. Attach the dispenser to the panel using four (4) supplied 1/4 x 20 screws.

Connecting Catch Basin Waste Drain

Installing the drain is highly recommended to prevent basin overflow.

The following steps cover the installation of the drain.

1. Remove the two screws attaching the drain basin to the water dispenser. Remove the drain basin.

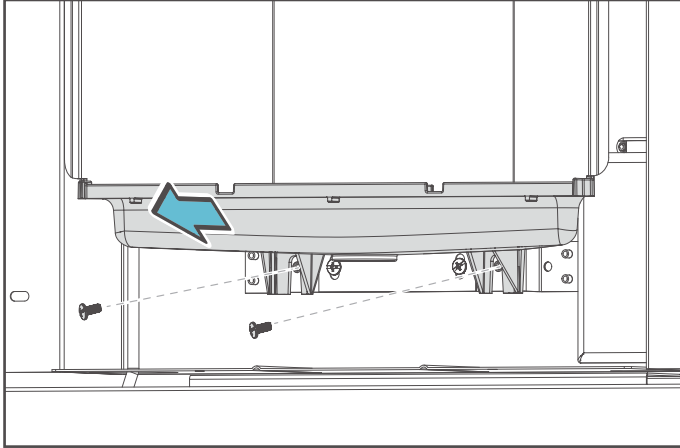

2. Place the drain basin on a flat, hard surface, such as a piece of sacrificial wood. Carefully drill a hole in the basin using a 1" hole saw using the centering-dimple as a guide to center the hole saw.

Note: Do not use a 1-1/8" hole saw as this will make the opening too large.

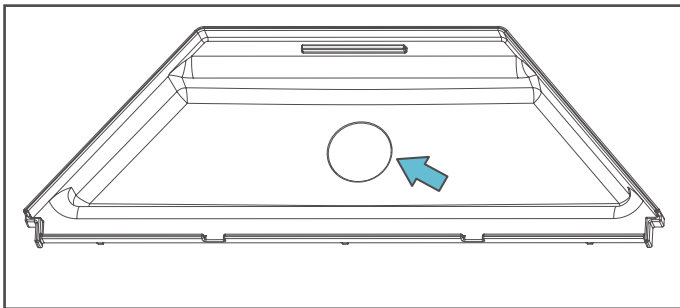

3. Trial fit the strainer. If the strainer does not fit, carefully open the size of the hole. If it fits well, place a small amount of plumber's putty around the lip of the strainer flange and insert it into the hole.

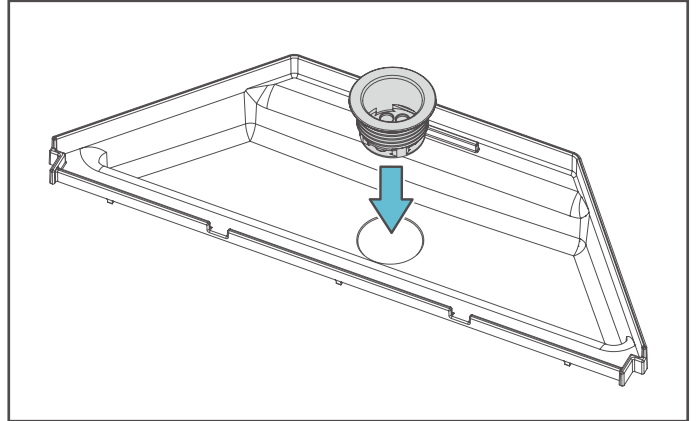

4. Install the O-ring over the strainer threads.

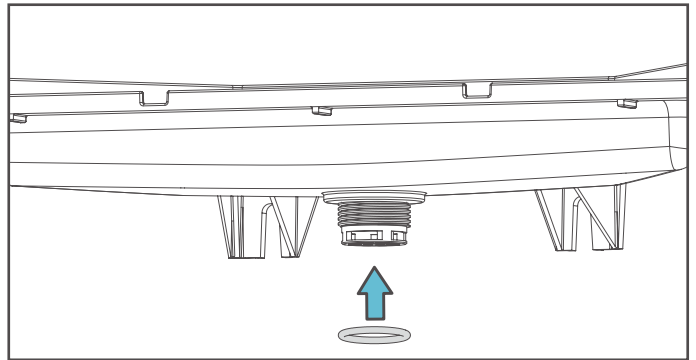

5. Thread the strainer into the drain adapter. Needle-nose pliers can be used to hold the drain adapter from the top while tightening. Ensure that the connection creates a watertight seal. The drain adapter must be facing to the left.

Note: Twisting the strainer instead of the drain adapter can compromise the seal created by the plumber's putty.

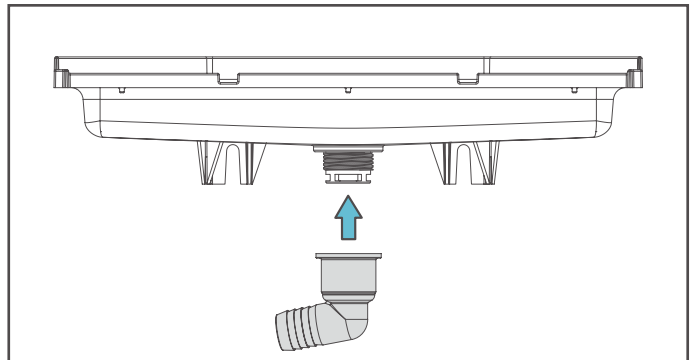

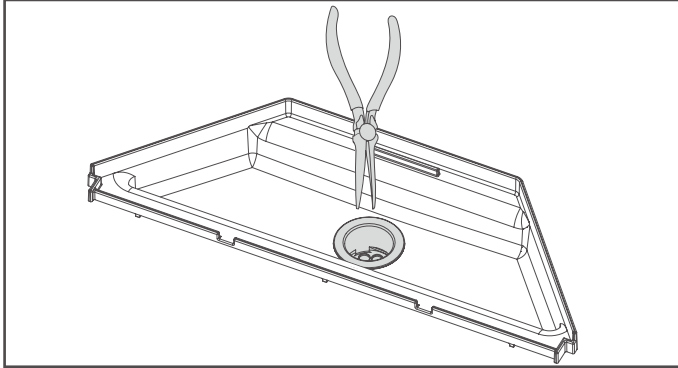

6. Attach one end of the 3/4 inch flexible drain hose to the 3/4 inch barbed drain adapter connection using the supplied hose clamp. The supplied flexible drain is 13 inches long. If a longer drain hose is required, it must be installer-supplied.

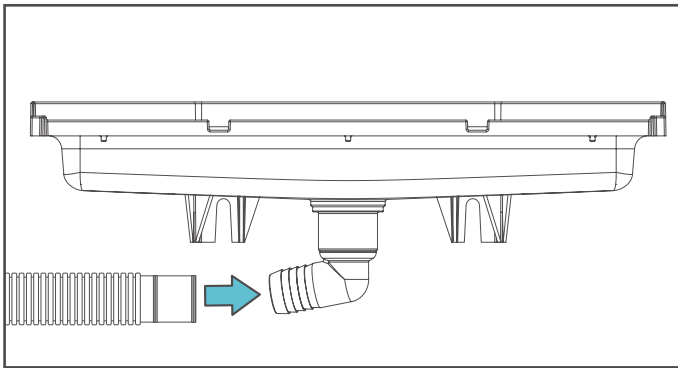

7. Place the drain basin back into the water dispenser and reinstall the two screws.

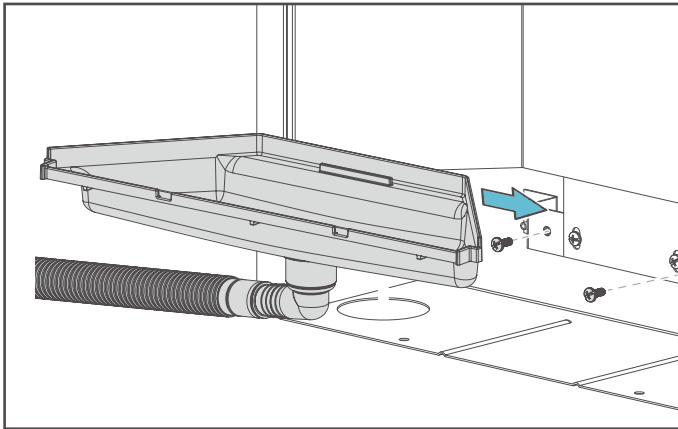

8. Connect the drain adapter into the household waste drain pipe.

If the p-trap is located inside a sealed walled, it must have permanently-glued joints. If the p-trap is in an accessible location, a standard non-glued p-trap is acceptable.

Install the water dispenser's front cover.

9. Line up the front panel with the dispenser frame and attach using the flathead screws and a 3/32" hex wrench.
10. Install the metal grate cover using the 4 Screws.

Note: Always consult local plumbing codes prior to installation.

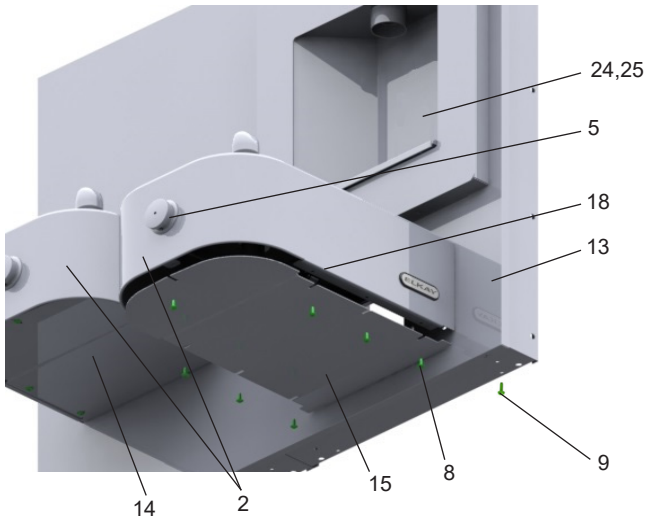
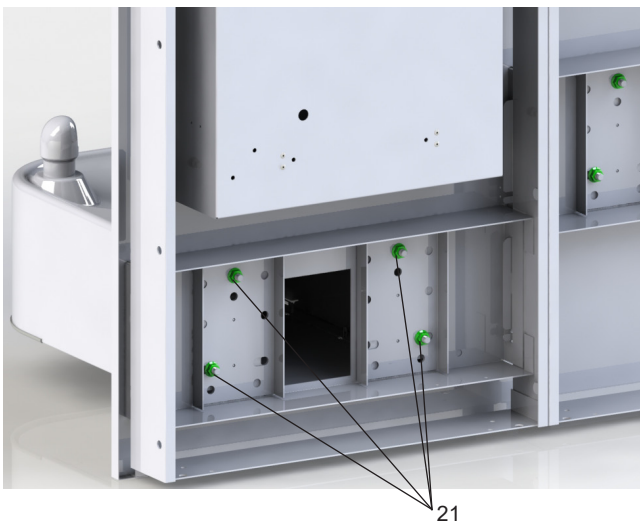
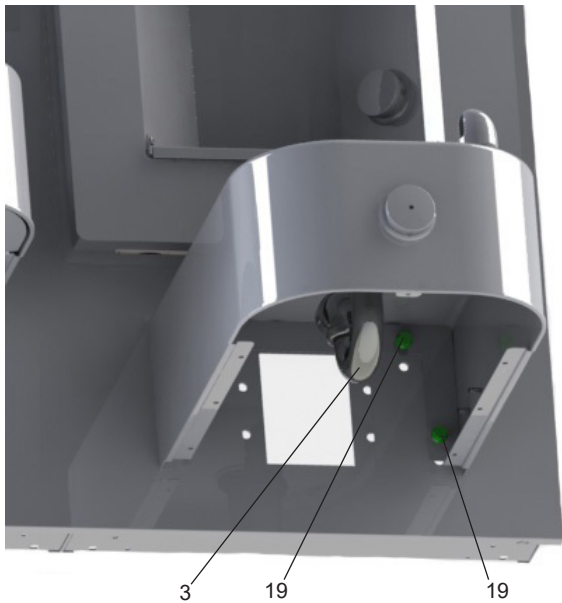

Figure 4 - Upper Panel Installation



View From Rear

Figure 5 - Fountain Installation

1. **Install** fountains with (8) 5/16-18 HHMS & (8) 5/16-18 nuts (provided) (Fig. 5). Connect the 1/4" water lines from each fountain to the remaining openings on the tee (cut lines to fit as needed).

2. **Attach** waste tubes (1-1/4" O.D.) to 1-1/4" O.D. slip trap. Trap on the bottle filler side must be 1-1/2" O.D. (provided by others).

3. **Make** final water supply connections.

4. **These** products are designed to operate on 20-105 PSI supply line pressure. If inlet pressure is above 105 PSI, a pressure regulator must be installed in the supply line.

Caution: Any damage caused by connecting these products to a supply line with pressure lower than 20 PSI or higher than 105 PSI IS NOT covered under warranty.

5. **Verify** proper dispensing from the bottle filler by placing a cup, under the water dispenser spout and press the button and verify water dispenses. **Note:** the first initial dispenses might have air in the line which may cause a sputter. This will be eliminated once all air is purged from the line. A steady stream of water assures all air is removed. Check for leaks.

6. **Check** stream height from bubbler. Stream height is factory set for 35 PSI supply. If supply pressure varies greatly from this, remove push button (Item 5 - Fig. 8) and adjust the screw on the regulator (Item 4 - Fig. 8). To remove push button, loosen set screw (Item 7 - Fig. 8) on bottom of the sleeve (Item 6 - Fig. 8) and pull out on the button. Clockwise adjustment will raise stream height and counterclockwise movement will lower stream height. For best adjustment stream should hit basin approximately 6-1/2" from the bubbler. Reassemble the push button by pushing in on button and tighten the set screw (Item 7 - Fig. 8) in the sleeve (Item 6 - Fig. 8).

7. **Install** the bottom cover plates on fountains (Fig. 4).

8. **Tighten** back panel screws (Item 9 - Fig. 4).

9. **Optional:** Mount optional panels. Mount bracket on wall per rough-in instructions. Slide tongue of panel under edge of already installed panel. Tighten screws. Once the installation is complete, the water has been turned on, and any trapped air has been bled from the system re-check for any water leaks.

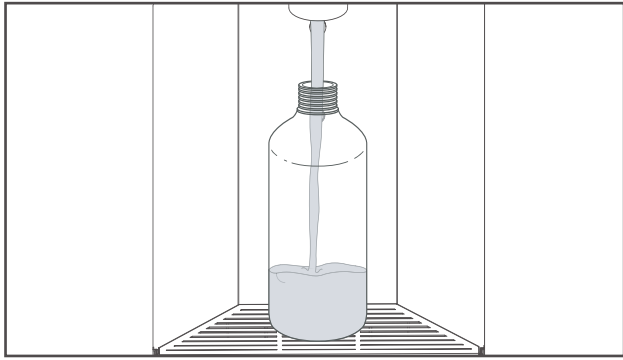

Once the installation is complete, the water has been turned on, and any trapped air has been bled from the system re-check for any water leaks.

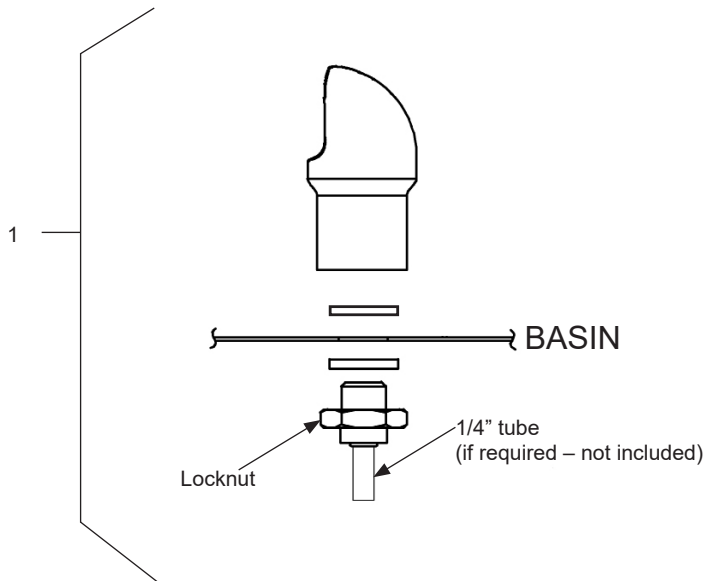

VANDAL-RESISTANT BUBBLER DETAIL

NOTE:
When installing replacement bubbler and pedestal, tighten locknut only to hold parts snug in position. **Do Not overtighten.**

Figure 6 - Bubbler Details

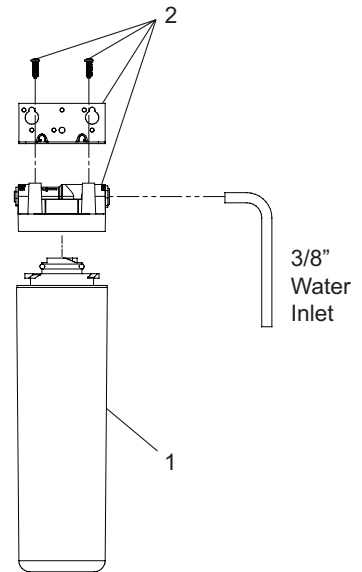

Filter Head Assembly
used after 01/01/2021

Fig. 7

WATERSENTRY® PLUS FILTER PARTS LIST (See Fig. 7)		
ITEM NO.	PART NO.	DESCRIPTION
1	51300C	Filter Assy-3000 Gal.
2	51469C	Assy-Filter & Brkt includes Filtr Head/Mtg Brkt/John Guest Fittings/Screws

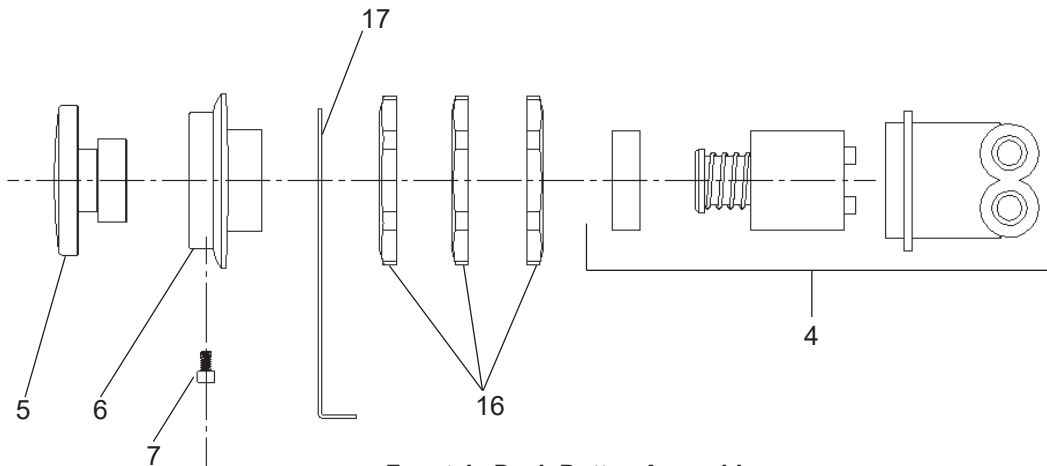

Fountain Push Button Assembly

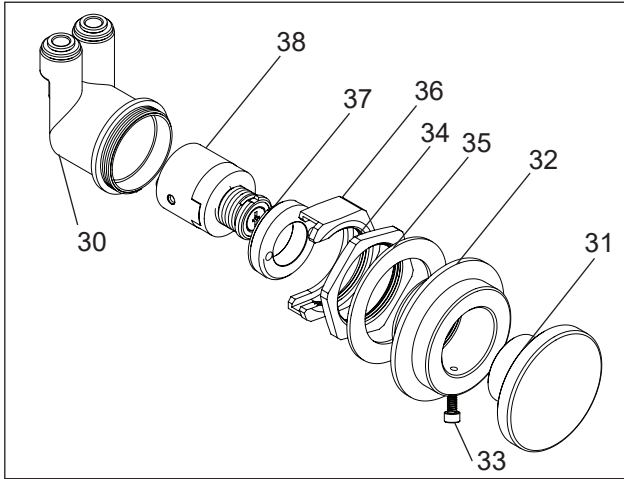

Figure 10 - Bottle Filler Push Button Assembly

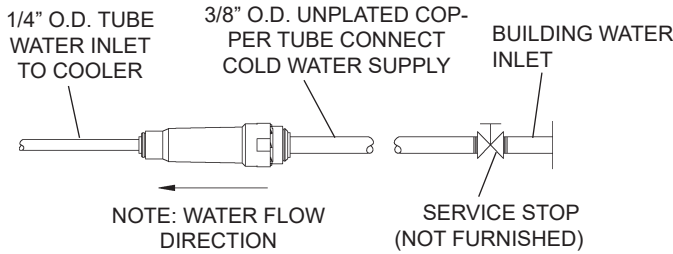

Figure 10 – Water Supply Connections

REPLACEMENT PART LIST

ITEM NO.	PART NO.	DESCRIPTION
24	98546C	Kit - Aerator Replacement
NS	1000004698	Fitting - Hose to Trap
25	2000001260	Kit - Alcove
26	1000005392	Kit - Drain
27	56331C	Connector
28	70793C	Elbow 1/4 O.D. X 90
29	1000001812	Kit - Bottle Filler Drain
30	50985C	Regulator Holder
31	45960C	Push Button
32	45663C	Push Button Sleeve
33	75672C	Screw - Cap #6-32 X 5/16
34	40045C	Hex Nut
35	28308C	Washer - Spacer 2.00 OD
36	45736C	Nut - Reg Mount
37	10031C	1-1/8-24 Retaining Nut
38	66822C	Regulator Assy. (1.0GPM)

NS = NOT SHOWN

OPERATION OF QUICK CONNECT FITTINGS

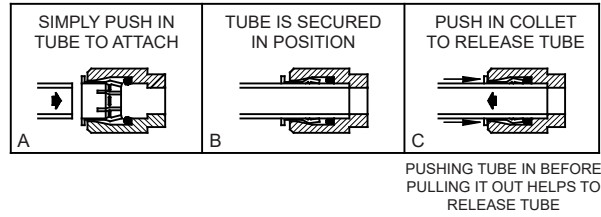

Figure 11 – Quick Connect Fittings

Installation Package

The components for installation are packed in three separate boxes, regardless of the type of unit being installed. The boxes contain the following:

- Box No. 1: Wall Frame(s)
- Box No. 2: Fountain(s), Arm(s) and Panels
- Box No. 3: Water Dispenser

Additional materials, as noted in the Parts List, are also shipped in these boxes.

TROUBLESHOOTING & MAINTENANCE

Orifice Assembly: Mineral deposits on orifice can cause water flow to spurt or not regulate. Mineral deposits may be removed from the orifice by poking with a small round file not over 1/8" diameter, or using a small diameter wire.

CAUTION: DO NOT file or cut orifice material.

Stream Regulator: If orifice is clean, regulate flow as in Step 14 of the installation instructions. If replacement is necessary, see parts list for correct regulator part number.

Actuation of Quick Connect Water Fittings: Cooler is provided with lead-free connectors which utilize an o-ring water seal. To remove tubing from the fitting, relieve water pressure, push in on the gray collar while pulling on the tubing. (See Fig. 11) To insert tubing, push tube straight into fitting until it reaches a positive stop (approximately 3/4").

FOR PARTS, CONTACT YOUR LOCAL DISTRIBUTOR OR CALL 1.800.834.4816
REPAIR SERVICE INFORMATION TOLL FREE NUMBER 1.800.260.6640