



# TOTAL PFAS FILTRATION SYSTEM, PRESSURE

The Total PFAS filter reduces some of the most pervasive and soon-to-be regulated PFAS contaminants\* regulated by the EPA in April 2024 - ideal for water cooler applications, whether installed in a drinking fountain or in the top of OASIS bottle fillers.

Total PFAS filter is certified to NSF/ANSI 42 for the reduction of Chlorine, Taste and Odor and Particulate Class I; NSF/ANSI 53 for the reduction of Cyst, Lead, Total PFAS; and NSF/ANSI 401 for the reduction of Microplastics.

Filter head supplied with 1/4" OD quick connect fittings for convenient connection to cooler using 1/4" OD tubing.

<b>Features:</b>	• Improves the taste and appearance of drinking water
	• Water filtration to reduce turbidity, dirt, rust, sediment, and to inhibit corrosion
	• Automatic shut-off valve inside the head engages as filter is inserted or removed
	• Uses the same filter head as the VersaFilter III System, allowing for easy filter cartridge replacement.
<b>Certified Claims:</b>	• For cold water supply line only
	• NSF/ANSI 42 for reduction of Chlorine, Taste, Odor and Particulate Class I
	• NSF/ANSI 53 for reduction of Lead, Cyst and Total PFAS
	• NSF/ANSI 401 for the reduction of Microplastics

<b>Temp:</b>	35°F (2°C) to 100°F (38°C)
<b>Flow Rate:</b>	1.1 gpm (5.16 Lpm)
<b>Pressure:</b>	20 psi (1.4 bar) to 125 psi (8.6 bar)
<b>Capacity:</b>	1,100 gals (4,164L)
<b>Service Life:</b>	12 months
<b>Sediment:</b>	Down to nominal 0.5 micron
<b>Function:</b>	Mechanical/Chemical Filtration
<b>Installation Location:</b>	For indoor use only

\*The test mixture for Total PFAS filter is made up of PFOA, PFOS, PFHxS, PFNA, PFHpA, PFBS, and PFDA.

Systems certified for cyst reduction may be used on disinfected water that may contain filterable cysts. Do not use with water that is microbiologically unsafe or of unknown quality without adequate disinfection before or after the system.



### Installation

- Rotate 1/4 turn right or left for installation or removal
- Universal kit shipped with complete instructions and mounting bracket.

### Accessories

- Replacement Cartridge: #041668-001
- Filter Head: #041146-001
- Universal Total PFAS Filter Kit, Pressure: #041253-005

### Certifications/Compliance

- NSF/ANSI 42, 53, 401 and 372

MODEL: \_\_\_\_\_ QTY: \_\_\_\_\_

PROJECT: \_\_\_\_\_

CONTACT: \_\_\_\_\_

NOTES: \_\_\_\_\_

APPROVAL: \_\_\_\_\_ DATE: \_\_\_\_\_



Specifications subject to change without notice

**Total PFAS Filter Head and Cartridge:**

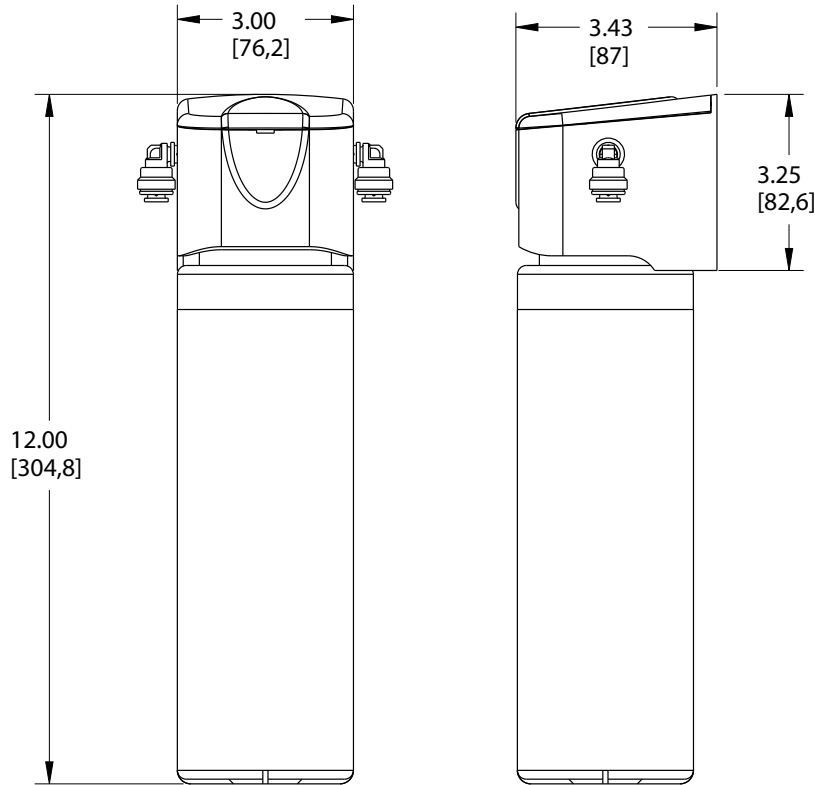

**Universal Total PFAS Filter Kit, Pressure Includes:**

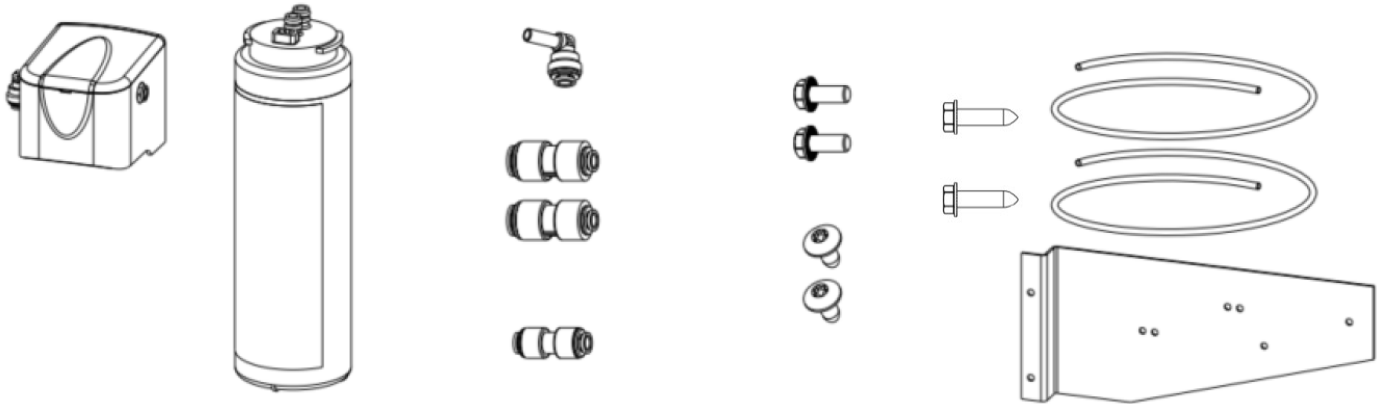

1. Filter Head Assembly with one Quick-Connect Elbow Fitting

2. Total PFAS Cartridge

3. 1/4" OD Quick-Connect Elbow Fitting

4. 3/8" OD x 1/4" OD Quick-Connect Reducing Union (Qty. 2) (If applicable)

5. 1/4" OD Quick-Connect (If applicable)

6. #8 x 3/8" Long Hex Head Tapping Blunt Screw (Qty. 2)

7. #8 x 3/8" Long T15 Torx Truss Head Tapping Screw (Qty. 2)

8. #8 x 5/8" Long Hex Head Self-Drilling Screw (Qty. 2) - for Bottle Filler Installation

9. 1/4" OD x 38" Long White Plastic Tubing (Qty. 2)

10. Filter Mounting Bracket